

**The Camden (Free Parking Places) (Disabled Persons) (Amendment No. 40) Traffic Order 2019**

**The Camden (Free Parking Places) (Dedicated Disabled) (Amendment No. XXXXXX) Traffic Order 2019**

**The Camden (Parking Places) (CA-H) (Amendment No. 15) Traffic Order 2019**

**The Camden (Parking Places) (CA-L) (Amendment No. 11) Traffic Order 2019**

**The Camden (Parking Places) (CA-P) (Amendment No. 20) Traffic Order 2019**

Notice is hereby given that the Council of the London Borough of Camden proposes to make the above Orders under Sections 6, 45, 46, 49 and 124 and Part IV of Schedule 9 to the Road Traffic Regulation Act 1984, as amended. The general nature and effect of the order are:

**Agamemnon Road, NW6:** revoke disabled persons' parking place (6.6 metres length) outside no. 31 Agamemnon Road and re-designate as permit holders parking space, contiguous with parking places either side.

**Downshire Hill, NW3:** revoke 6.6m of permit holders parking place outside no. 52 Downshire Hill and re-designate as a dedicated disabled person's parking place for the use of a specified permit holder.

**Lyncroft Gardens, NW6:** revoke 6.6m of permit holders parking place outside nos. 50 – 60 Lyncroft Mansions and re-designate as a disabled persons' parking place.

**Willes Road, NW5:** revoke 6.6m of permit holders parking place outside no. 45 Willes Road and re-designate as a disabled persons' parking place.

Copies of the proposed orders and the Council's Statement of Reasons for proposing to make the orders may be obtained by contacting [traffic.orders@camden.gov.uk](mailto:traffic.orders@camden.gov.uk) or inspected at the council's offices at 5 Pancras Square, N1C 4AG. Any person wishing to object or make representations in respect of the proposed orders, should send comments in writing, giving reasons for any objection to [TransportConsultations@camden.gov.uk](mailto:TransportConsultations@camden.gov.uk) or by post to the Director of Regeneration & Planning, Supporting Communities Directorate, Camden Town Hall, Judd Street, London WC1H 9JE, to be received by the end of 28 February 2019.

Peter Mardell  
Head of Parking Operations  
7 February 2019

**The Camden (Free Parking Places) (Disabled Persons) (Amendment No. 40) Traffic Order 2019**

**The Camden (Free Parking Places) (Dedicated Disabled) (Amendment No. XXXXXX) Traffic Order 2019**

**The Camden (Parking Places) (CA-H) (Amendment No. 15) Traffic Order 2019**

**The Camden (Parking Places) (CA-L) (Amendment No. 11) Traffic Order 2019**

**The Camden (Parking Places) (CA-P) (Amendment No. 20) Traffic Order 2019**

## **STATEMENT OF REASONS**

The orders would either designate parking places for the use of disabled persons following requests from individuals, or revoke similar but redundant parking places.

Distance to end of resident permit holder bay

Convert 6.6m of existing resident permit holder space to general disabled space

Distance to existing general disabled space

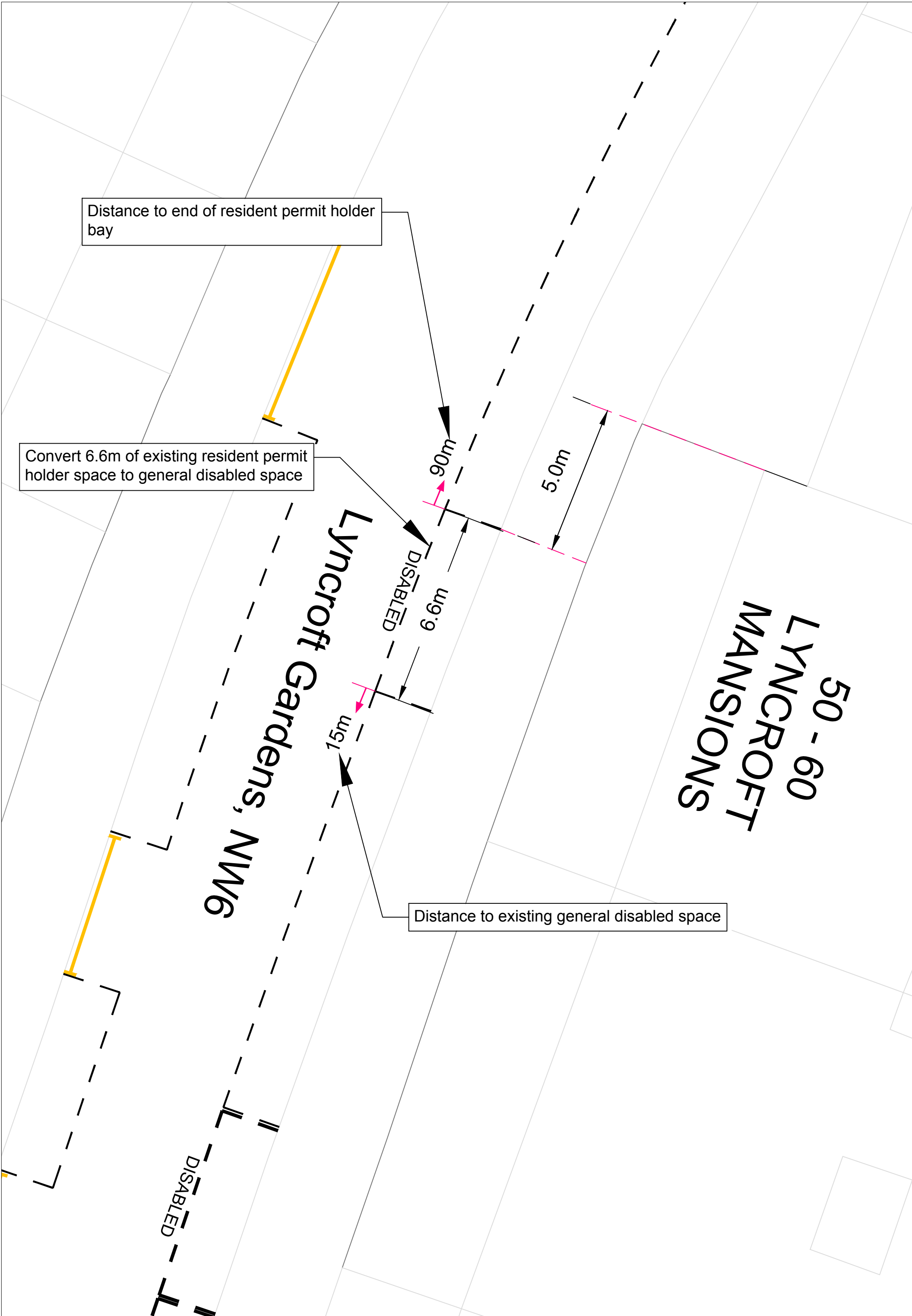



**P** Permit holders only  
 → CA - L  
 Mon - Fri  
 8:30 am - 6:30 pm

**P** Disabled badge holders only  

**New sign on lamp column**

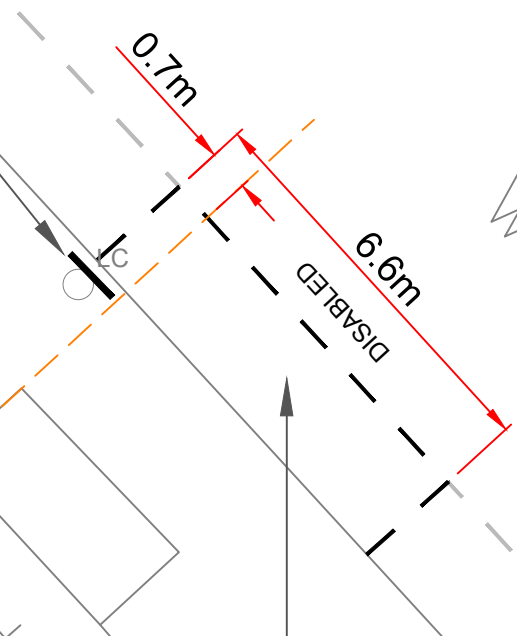

**1x Permit parking place to be removed and replaced with a new disabled persons parking place**

WILLES ROAD

Rev	By	Date	Amendments

**Camden**  
 Design Team  
 Transport Strategy Service  
 London Borough of Camden  
 5 Pancras Square  
 Tel 020 7974 5551, Fax 020 7974 6952  
 DX 2106 Euston, Minicom 020 7974 6866

Project  
**Proposal**

Drawing Title  
**45 Willes Road**

Scale <b>NTS</b>	Date <b>14-12-18</b>
Drawn By <b>NHS</b>	File Ref <b>GDB-06 45</b>
Checked By <b>MW</b>	Dwg Name <b>-</b>
Drawing Location <b>-</b>	Drawing Number <b>-</b>
	Rev. <b>-</b>

--- Road markings to be removed

GONDAR GARDENS, NW6

AGAMMENNON ROAD, NW6

DISABLED

20m

6.6m

3.4m

Remove 6.6m general disabled space and provide residents permit holder space

35

33

31

37

6

8

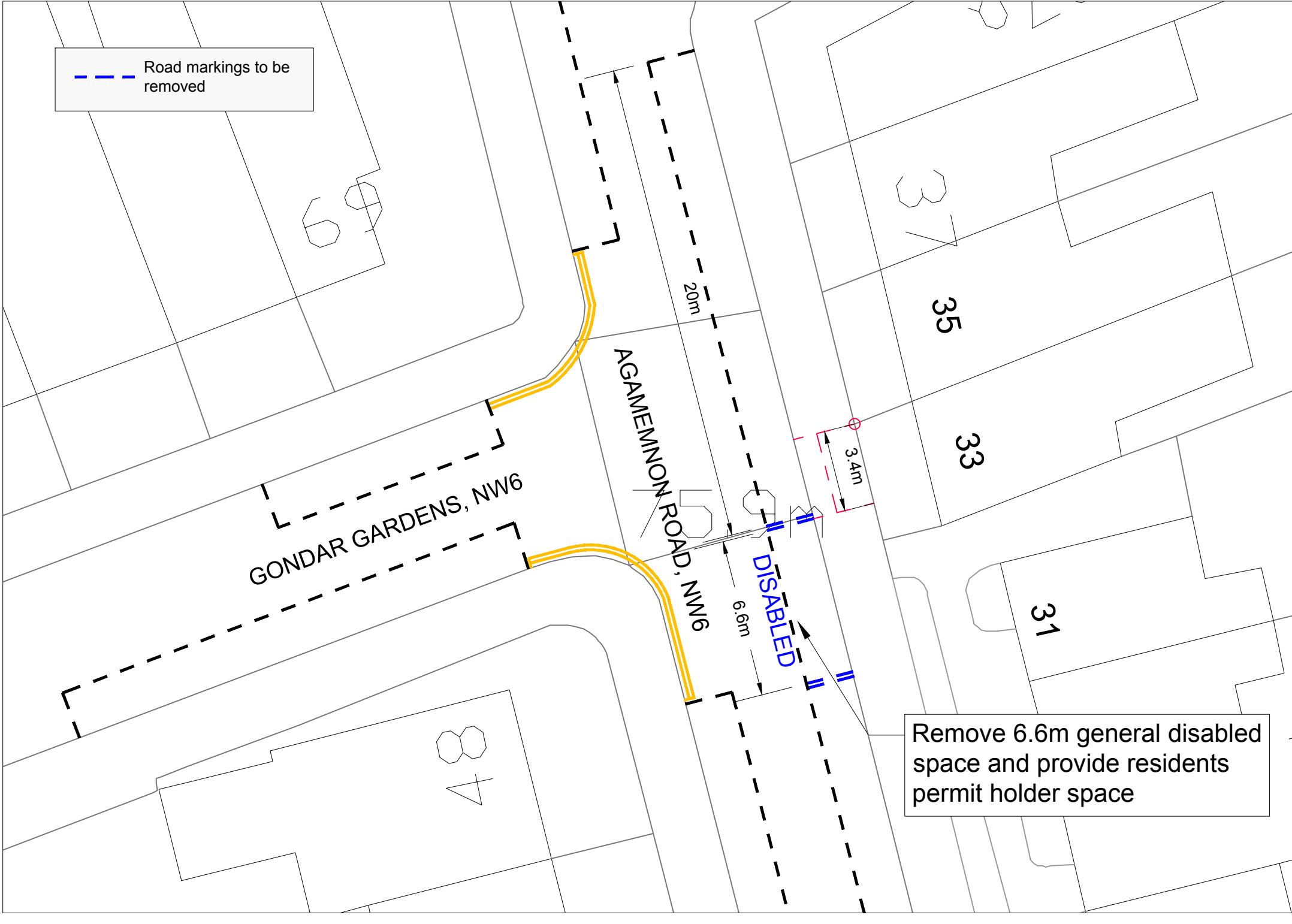

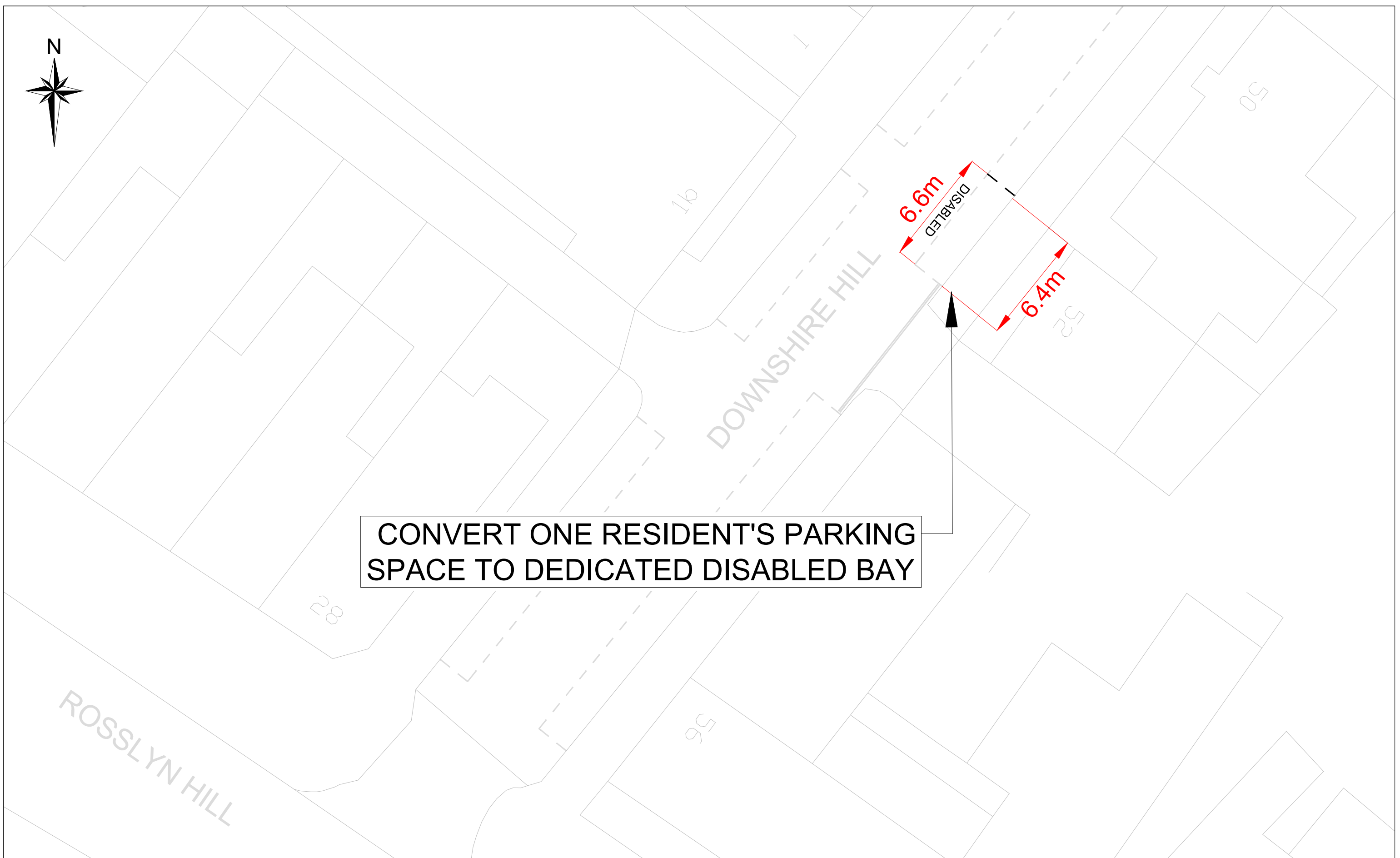

**CONVERT ONE RESIDENT'S PARKING SPACE TO DEDICATED DISABLED BAY**

**Camden**  
 Design Team  
 Transport Strategy Service  
 London Borough of Camden  
 5 Pancras Square  
 Tel 020 7974 5551, Fax 020 7974 6952  
 DX 2106 Euston, Minicom 020 7974 6866

Project  
**DOWNSHIRE HILL  
 DEDICATED DISABLED BAY**

Drawing Title  
**TMO**

**KEY**  
 - Existing road marking  
 - Proposed road marking

Rev	By	Date	Amendments

Scale <b>NTS</b>	Date <b>30.07.2018</b>
Drawn By <b>RW</b>	File Ref
Checked By <b>AC</b>	Dwg Name
Drawing Location <b>Traffic Engineering\Non Capital Schemes\2018-19</b>	
Drawing Number <b>TS/RW/DOWNSHIRE HILL - TMO</b>	Rev. <b>A</b>

# **The Camden (Free Parking Places) (Disabled Persons) (Amendment No. 40) Traffic Order 2019**

**2019 No. 6**

**AGAMEMNON ROAD  
LYNCROFT GARDENS  
WILLES ROAD**

# LONDON BOROUGH OF CAMDEN

## TRAFFIC MANAGEMENT ORDER

2019 No.6

---

### The Camden (Free Parking Places) (Disabled Persons) (Amendment No. 40) Traffic Order 2019

Made on

Coming into force on

---

The Council of the London Borough of Camden after consulting the Commissioner of Police of the Metropolis, in exercise of powers conferred by sections 6 and 124 of and Part IV of schedule 9 to the Road Traffic Regulation Act 1984, as amended by section 8 of and Part I of Schedule 5 to the Local Government Act 1985 and Part 6 of the Traffic Management Act 2004 and all other powers thereunto enabling, hereby make the following Order:

#### **1. Citation and commencement**

- 1.1 This Order shall come into force on \_\_\_\_\_ and may be cited as the Camden (Free Parking Places) (Disabled Persons) (Amendment No. 40) Traffic Order 2019.

#### **2. Interpretation**

- 2.1 In this order:
- 2.1.1 the term “parent order” means the Camden (Free Parking Places) (Disabled Persons) Traffic Order 2012 [L.B.C. 2012 No. 22].
- 2.1.2 any reference in this order to any enactment shall be construed as a reference to that enactment as amended, applied, consolidated, re-enacted by or as having effect by virtue of any subsequent enactment;
- 2.1.3 unless the context otherwise requires, any expression used in this order which is also used in the parent order shall have the same meaning as in that order.

#### **3. Revocation and designation of parking places**

- 3.1 Without prejudice to the validity of anything done or to any liability incurred in respect of any act or omission before the coming into force of this order the parent order shall have effect as though;
- 3.1.1 there was omitted from the schedule to the parent order, the item set out in table 1 of the schedule to this order;
- 3.1.2 there were included in the schedule to the parent order, the items set out in table 2 of the schedule to this order.



**Dated this**

## SCHEDULE

TABLE 1 – ITEMS OMITTED FROM THE SCHEDULE TO THE PARENT ORDER

ITEM NUMBER	STREET	LENGTH OF HIGHWAY	CONTROLLED HOURS
12723	AGAMEMNON ROAD	North to South Arm; east side, from the southern flank wall of nos. 33 Agamemnon Road, southward for a distance of 6.6 metres.	AT ANY TIME

TABLE 2 – ITEMS INCLUDED IN THE SCHEDULE TO THE PARENT ORDER

ITEM NUMBER	STREET	LENGTH OF HIGHWAY	CONTROLLED HOURS
13231	LYNCROFT GARDENS	south-east side; from a point 5 metres south-west of the north-eastern boundary wall of nos. 50 – 60 Lyncroft Mansions, south-westwards for a distance of 6.6 metres	AT ANY TIME
13229	WILLES ROAD	south-west side, from a point 0.7 metres north-west of the extended party wall of nos. 45 and 47 Willes Road, south-eastwards for a distance of 6.6 metres	AT ANY TIME

# **The Camden (Parking Places) (CA-H) (Amendment No. 15) Traffic Order 2019**

**2019 No. 7**

**DOWNSHIRE HILL**

# LONDON BOROUGH OF CAMDEN

## TRAFFIC MANAGEMENT ORDER

### 2019 No. 7

The Camden (Parking Places) (CA-H) (Amendment No. 15) Traffic Order 2018

Made on

Coming into force on

---

The Council of the London Borough of Camden, after consulting the Commissioner of Police of the Metropolis, in exercise of the powers conferred by sections 45, 46, 49 and 124 of and part IV of schedule 9 to the Road Traffic Regulation Act 1984 [1984 c. 27], as amended by section 8 of and part I of schedule 5 to the Local Government Act 1985 [1985 c. 51], and of all other powers thereunto enabling, hereby make the following order:

#### **1. Citation and commencement**

- 1.1 This Order shall come into force on \_\_\_\_\_ and may be cited as The Camden (Parking Places) (CA-H) (Amendment No. 15) Traffic Order 2019.

#### **2. Interpretation**

2.1 In this order:

- 2.1.1 the term "parent order" means the Camden (Parking Places) (CA-H) (Traffic Order 2012 [L.B.C 2012 No. 8];
- 2.1.2 any reference in this order to any other order or enactment shall be construed as a reference to that order or enactment as amended, applied, consolidated, re-enacted by or as having effect by virtue of any subsequent order or enactment;
- 2.1.3 unless the context otherwise requires, any expression used in this order which is also used in the parent order shall have the same meaning as in that order.

#### **3. Revocation and designation of parking places**

- 3.1 Without prejudice to the validity of anything done or to any liability incurred in respect of any act or omission before the coming into force of this order the parent order shall have effect as though:
- 3.1.1 there was omitted from schedule 1 to the parent order the items set out in table 1 of the schedule to this order;
- 3.1.2 there was included in schedule 1 to the parent order the items set out in table 2 of the schedule to this order;

**Dated this**

## SCHEDULE

TABLE 1 - ITEMS OMITTED FROM SCHEDULE 1 TO THE PARENT ORDER

ITEM NUMBER	STREET	LENGTH OF HIGHWAY	CONTROLLED HOURS
3155	DOWNSHIRE HILL	the south-east side, from 2 metres north-east of a point opposite the south-western flank wall of no. 52 Downshire Hill, to 1 metre south-west of a point opposite the north-eastern flank wall of no. 49 Downshire Hill.	MONDAY - SATURDAY 9AM - 8PM

TABLE 2 – ITEMS INCLUDED IN SCHEDULE 1 TO THE PARENT ORDER

ITEM NUMBER	STREET	LENGTH OF HIGHWAY	CONTROLLED HOURS
13242	DOWNSHIRE HILL	south-east side, from the common boundary of nos. 51 and 52 Downshire Hill, to a point 1 metre south-west of the north-eastern flank wall of no. 49 Downshire Hill.	MONDAY - SATURDAY 9AM - 8PM

# **The Camden (Parking Places) (CA-L) (Amendment No. 11) Traffic Order 2019**

**2019 No. 8**

**WILLES ROAD**

# LONDON BOROUGH OF CAMDEN

## TRAFFIC MANAGEMENT ORDER

### 2019 No. 8

The Camden (Parking Places) (CA-L) (Amendment No. 11) Traffic Order 2018

Made on

Coming into force on

---

The Council of the London Borough of Camden, after consulting the Commissioner of Police of the Metropolis, in exercise of the powers conferred by sections 45, 46, 49 and 124 of and part IV of schedule 9 to the Road Traffic Regulation Act 1984 [1984 c. 27], as amended by section 8 of and part I of schedule 5 to the Local Government Act 1985 [1985 c. 51], and of all other powers thereunto enabling, hereby make the following order:

#### **1. Citation and commencement**

- 1.1 This Order shall come into force on \_\_\_\_\_ and may be cited as The Camden (Parking Places) (CA-L) (Amendment No. 11) Traffic Order 2019.

#### **2. Interpretation**

2.1 In this order:

- 2.1.1 the term "parent order" means the Camden (Parking Places) (CA-L) (Traffic Order 2012 [L.B.C 2012 No. 12];
- 2.1.2 any reference in this order to any other order or enactment shall be construed as a reference to that order or enactment as amended, applied, consolidated, re-enacted by or as having effect by virtue of any subsequent order or enactment;
- 2.1.3 unless the context otherwise requires, any expression used in this order which is also used in the parent order shall have the same meaning as in that order.

#### **3. Revocation and designation of parking places**

- 3.1 Without prejudice to the validity of anything done or to any liability incurred in respect of any act or omission before the coming into force of this order the parent order shall have effect as though:
- 3.1.1 there was omitted from schedule 1 to the parent order the items set out in table 1 of the schedule to this order;
- 3.1.2 there was included in schedule 1 to the parent order the items set out in table 2 of the schedule to this order;



**Dated this**

## SCHEDULE

TABLE 1 - ITEMS OMITTED FROM SCHEDULE 1 TO THE PARENT ORDER

ITEM NUMBER	STREET	LENGTH OF HIGHWAY	CONTROLLED HOURS
4300	WILLES ROAD	the south-west side, from a point 6 metres north-west of its junction with Inkerman Road, north-westwards for a distance of 90 metres.	MONDAY - FRIDAY 8.30AM - 6.30PM

TABLE 2 – ITEMS INCLUDED IN SCHEDULE 1 TO THE PARENT ORDER

ITEM NUMBER	STREET	LENGTH OF HIGHWAY	CONTROLLED HOURS
13227	WILLES ROAD	south-west side, from a point 6 metres north-west of its junction with Inkerman Road, north-westwards for a distance of 28 metres.	MONDAY - FRIDAY 8.30AM - 6.30PM
13228	WILLES ROAD	south-west side, from a point 40.6 metres north-west of its junction with Inkerman Road, north-westwards for a distance of 55.4 metres.	MONDAY - FRIDAY 8.30AM - 6.30PM

# **The Camden (Parking Places) (CA-P) (Amendment No. 20) Traffic Order 2019**

**2019 No. 9**

**AGAMEMNON ROAD  
LYNCROFT GARDENS**

# LONDON BOROUGH OF CAMDEN

## TRAFFIC MANAGEMENT ORDER

### 2019 No. 9

The Camden (Parking Places) (CA-P) (Amendment No. 20) Traffic Order 2019

Made on

Coming into force on

---

The Council of the London Borough of Camden, after consulting the Commissioner of Police of the Metropolis, in exercise of the powers conferred by sections 45, 46, 49 and 124 of and part IV of schedule 9 to the Road Traffic Regulation Act 1984 [1984 c. 27], as amended by section 8 of and part I of schedule 5 to the Local Government Act 1985 [1985 c. 51], and of all other powers thereunto enabling, hereby make the following order:

#### **1. Citation and commencement**

- 1.1 This Order shall come into force on \_\_\_\_\_ and may be cited as The Camden (Parking Places) (CA-P) (Amendment No. 20) Traffic Order 2019.

#### **2. Interpretation**

2.1 In this order:

- 2.1.1 the term "parent order" means the Camden (Parking Places) (CA-P) (Traffic Order 2012 [L.B.C 2012 No. 19];
- 2.1.2 any reference in this order to any other order or enactment shall be construed as a reference to that order or enactment as amended, applied, consolidated, re-enacted by or as having effect by virtue of any subsequent order or enactment;
- 2.1.3 unless the context otherwise requires, any expression used in this order which is also used in the parent order shall have the same meaning as in that order.

#### **3. Revocation and designation of parking places**

- 3.1 Without prejudice to the validity of anything done or to any liability incurred in respect of any act or omission before the coming into force of this order the parent order shall have effect as though:
- 3.1.1 there was omitted from schedule 1 to the parent order the items set out in table 1 of the schedule to this order;
- 3.1.2 there was included in schedule 1 to the parent order the items set out in table 2 of the schedule to this order;

**Dated this**

## SCHEDULE

TABLE 1 - ITEMS OMITTED FROM SCHEDULE 1 TO THE PARENT ORDER

ITEM NUMBER	STREET	LENGTH OF HIGHWAY	CONTROLLED HOURS
12757	AGAMEMNON ROAD	(north to south arm), east side, from a point 3.6 metres north of the northern flank wall of no.37 Agamemnon Road, southward for a distance of 20 metres.	MONDAY – FRIDAY 10AM - NOON
12758	AGAMEMNON ROAD	(north to south arm), east side, from a point 6.6 metres south of the southern flank wall of no.33 Agamemnon Road, southward for a distance of 53 metres, to a point 4.6 metres north of the northern kerb-line of Ulysses Road.	MONDAY – FRIDAY 10AM - NOON
12238	LYNCROFT GARDENS	the south-east side; from a point 14.5 metres south-west of the south-western kerb line of Finchley Road, south-westwards for a distance of 110.5 metres.	MONDAY – FRIDAY 8.30AM – 6.30PM

TABLE 2 – ITEMS INCLUDED IN SCHEDULE 1 TO THE PARENT ORDER

ITEM NUMBER	STREET	LENGTH OF HIGHWAY	CONTROLLED HOURS
13230	AGAMEMNON ROAD	(north to south arm), east side, from a point 3.6 metres north of the northern flank wall of no.37 Agamemnon Road, southward for a distance of 79.6 metres, to a point 4.6 metres north of the northern kerb-line of Ulysses Road.	MONDAY – FRIDAY 10AM - NOON
13232	LYNCROFT GARDENS	south-east side; from a point 14.5 metres south-west of the south-western kerb line of Finchley Road, south-westwards for a distance of 90 metres.	MONDAY – FRIDAY 8.30AM – 6.30PM
13233	LYNCROFT GARDENS	south-east side; from a point 11.6 metres south-west of the north-eastern boundary wall of nos. 50 – 60 Lyncroft Mansions, south-westwards for a distance of 15 metres	MONDAY – FRIDAY 8.30AM – 6.30PM

# **The Camden (Parking Places) (Dedicated Disabled) (Amendment No. 40) Traffic Order 2019**

**2019 No. 14**

**DOWNSHIRE HILL**

# LONDON BOROUGH OF CAMDEN

## TRAFFIC MANAGEMENT ORDER

2019 No. 14

---

### **The Camden (Parking Places) (Dedicated Disabled) (Amendment No. 40) Traffic Order 2019**

Made on

Coming into force on

---

The Council of the London Borough of Camden after consulting the Commissioner of Police of the Metropolis, in exercise of powers conferred by sections 6 and 124 of and Part IV of schedule 9 to the Road Traffic Regulation Act 1984, as amended by section 8 of and Part I of Schedule 5 to the Local Government Act 1985 and Part 6 of the Traffic Management Act 2004 and all other powers thereunto enabling, hereby make the following Order:

#### **1. Citation and commencement**

- 1.1 This Order shall come into force on \_\_\_\_\_ and may be cited as the Camden (Parking Places) (Dedicated Disabled) (Amendment No. 40) Traffic Order 2019.

#### **2. Interpretation**

2.1 In this order:

2.1.1 the term “parent order” means the Camden (Parking Places) (Dedicated Disabled) Traffic Order 2012 [L.B.C. 2012 No. 23].

2.1.2 any reference in this order to any enactment shall be construed as a reference to that enactment as amended, applied, consolidated, re-enacted by or as having effect by virtue of any subsequent enactment;

2.1.3 unless the context otherwise requires, any expression used in this order which is also used in the parent order shall have the same meaning as in that order.

#### **3. Designation of parking place**

- 3.1 Without prejudice to the validity of anything done or to any liability incurred in respect of any act or omission before the coming into force of this order the parent order shall have effect as though there was included in the schedule to the parent order, the items set out in the table of the schedule to this order.



**Dated this**

## SCHEDULE

TABLE – ITEM INCLUDED IN THE SCHEDULE TO THE PARENT ORDER

ITEM NUMBER	STREET	LENGTH OF HIGHWAY	CONTROLLED HOURS
13241	DOWNSHIRE HILL	south-east side, from a point 2 metres north-east of the south-western flank wall of no. 52 Downshire Hill, north-eastwards for a distance of 6.6 metres	AT ANY TIME