

IN THE Highbury Corner Magistrates Court
Highways Act 1980 - Section 116

BEFORE the Magistrates' Court sitting at 51 Holloway Road, London, N7 8JA

APPLICATION having been made by the London Borough of Camden (the Applicant) under section 116 of the Highways Act 1980 that an area of the highway being land outside the Network Building, (95-100 Tottenham Court Road, 76-80 Whitfield Street, and 88 Whitfield Street) in Whitfield Street (Area A) and Howland Street (Area B) situated within the London Borough of Camden with the following description:

The rear of the footway adjacent to the Network Building (95-100 Tottenham Court Road, 76-80 Whitfield Street, and 88 Whitfield Street) in Whitfield Street, north of the former brick vents (Area A) and Howland Street at the junction of the former Cypress Place (Area B) as per the table below:

	Length (metres)	Width (metres)	Area (m ²)	Terminal Points	
				From	To
Area A	Between 6.808 and 6.814	Between 1.562 and 1.611	10.81	Whitfield Street: The northern flank wall of the former brick vents	Whitfield Street: 6.8m north of the northern flank wall of the former brick vents
Area B	Between 8.132 and 8.824	Between 1.390 and 1.722	13.72	Howland Street at the junction of the former Cypress Place	Howland Street at the junction of the former Cypress Place

The highway shown hatched on plan 4312/SK004/D (the Existing Highway) should be stopped on the ground that it is unnecessary.

The order will not change the rights of any statutory utilities to access and maintain their plant or equipment.

AND the Court being satisfied that the Applicant has given the notices required by Part 1 of Schedule 12 to the Highways Act 1980 and that the written consent of every person having a legal interest in the land over which the highway is to be diverted has been obtained

AND the Court having heard the Application.

AND the Court being satisfied that the said area of highway is unnecessary.

IT IS HEREBY ORDERED that the said area of highway be authorised to be stopped up for the purposes of all traffic.

DATED 7.8.25

JUSTICE OF THE PEACE

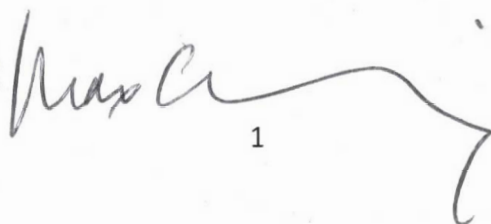
1

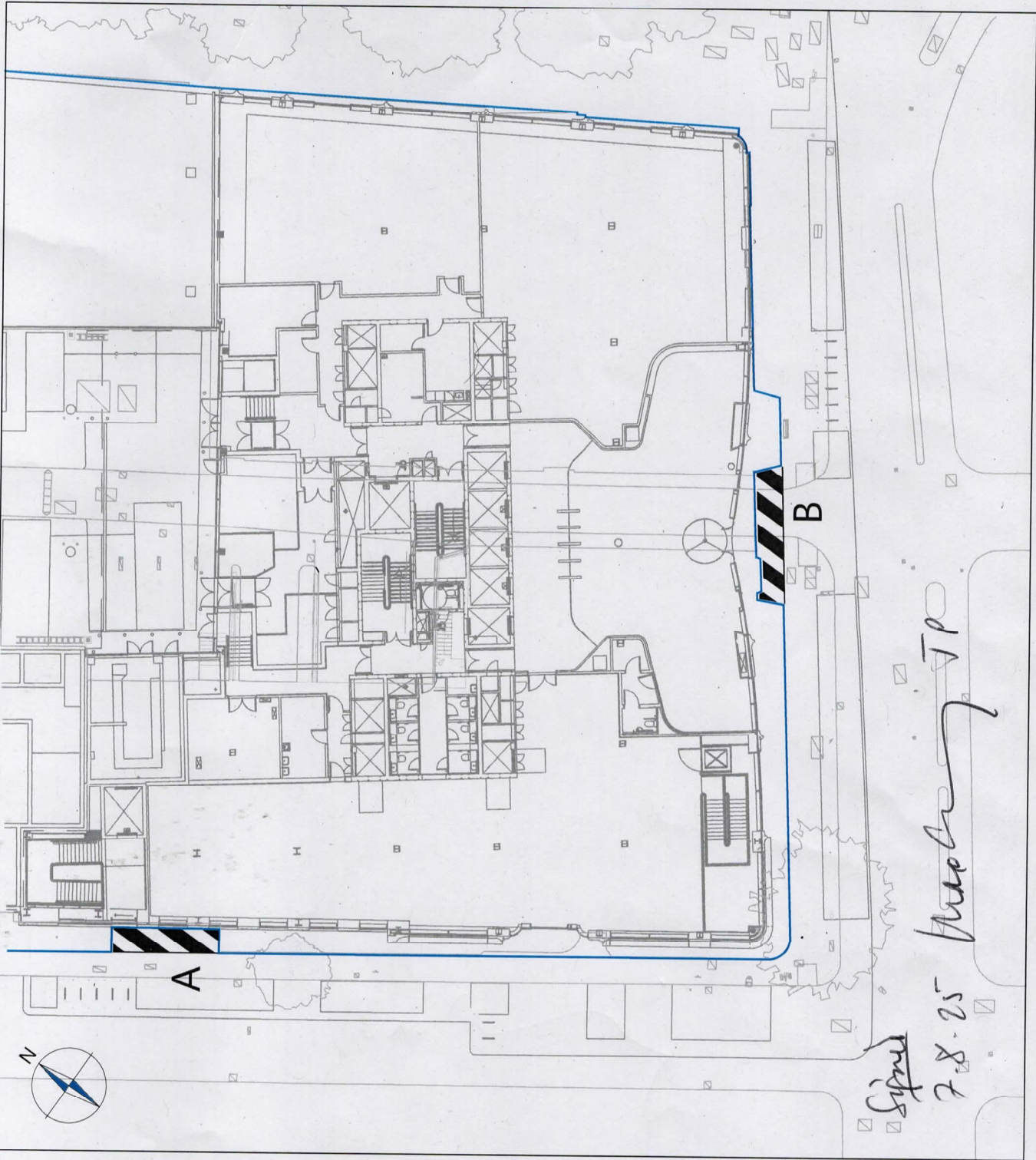

Sign
7.8.25
TP

NOTES

1. This drawing to be read & printed in colour.
2. This drawing is for illustrative purposes only.

KEY:

HIGHWAY BOUNDARY

STOPPING UP AREA

AREAS

A = 10.81m²

B = 13.72m²

Total = 24.53m²

Rev	Details	Drawn	Checked	Date
D	Minor change to stopping up area	RB	SMCC	01.11.2024
C	Minor change to stopping up area	HE	SMCC	29.10.2024
B	Latest stopping up areas	HE	SMCC	17.10.2024
A	Updated based on client comments	JS	JT	06.10.2023

REVISION HISTORY

Status: ☒ Preliminary ☐ Detailed ☐ As Built

Client:

Derwent Valley Property
Development Limited

Project:

Network Building

Drawing Title

Stopping Up Plan

Scale:

1:250

Size:

A3

Drawn by:

JS

Checked by:

JT

Approved by:

JT

Date:

14.09.2023

CANEPARO ASSOCIATES
Transport Planning & Highway Design
21 Little Portland Street • London • W1W 6BT • Tel: 020 3617 8200

Scheme Ref:

4312

Drawing No:

SK004

Sheet:

1 of 1

Rev:

D